

Woodmere Avenue, Shirley Oaks

Guide Price £600,000

🛏 3 🚗 2 🚗 2



Please Quote Ref TH0310 For All Enquiries - Beautifully presented three bedroom, two bathroom, detached bungalow (1614 Sq. Ft) with off street parking, large garden and garage, superbly located in sought after Shirley Oaks Village. Offering expansive accommodation, superbly appointed, with quality finish throughout.

Key Features

- Beautiful Three Bedroom Detached Bungalow (1614 Sq. Ft)
- Two Bright and Spacious Reception Rooms
- Well Equipped Kitchen/Diner
- Large Private Garden
- Close to Transport Links, Schools and Amenities
- Sought After Shirley Oaks Location
- Large Sunny Conservatory
- Family Bathroom Plus En-Suite Wet Room
- Off Street Parking and Garage
- Please Quote Ref; TH0310 For All Enquiries

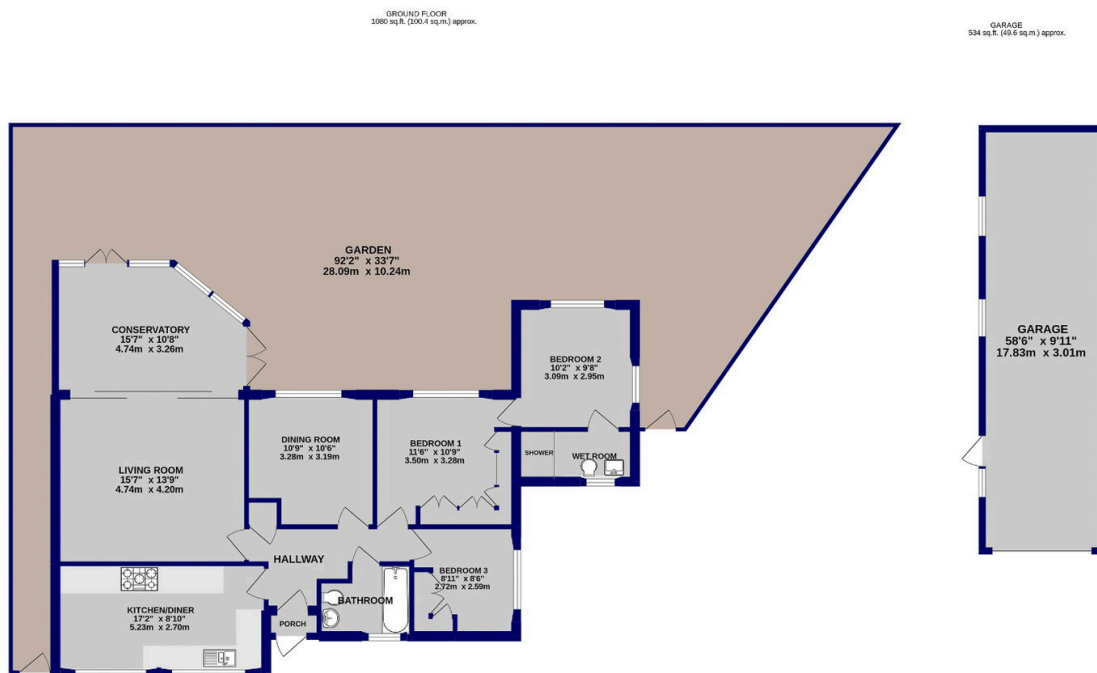

TOTAL FLOOR AREA : 1614 sq.ft. (150.0 sq.m.) approx.

Whilst every attempt has been made to ensure the accuracy of the floorplan contained here, measurements of doors, windows, rooms and any other items are approximate and no responsibility is taken for any error, omission or mis-statement. This plan is for illustrative purposes only and should be used as such by any prospective purchaser. The services, systems and appliances shown have not been tested and no guarantee as to their operability or efficiency can be given.

THOMAS HOWE
exp UK